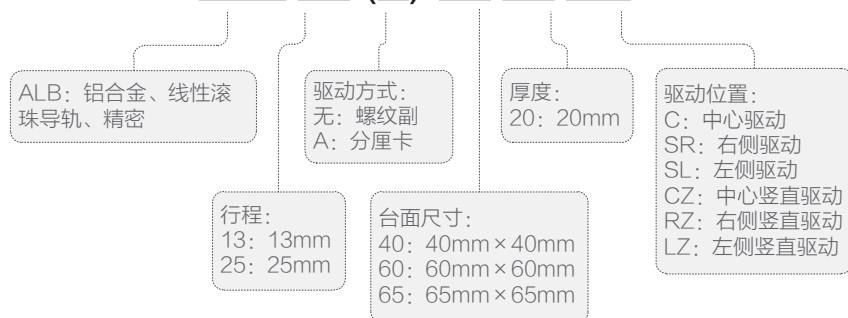
**说明：**

ALB 系列是卓立汉光最新推出的手动精密滑台。该系列产品主体材料采用 2024 铝合金,表面氧化黑处理,精度较高、耐磨性好、外形美观。产品采用线性滚珠导轨导向,精密分厘卡(或微调螺纹副)驱动,具有很高的性价比。该系列产品尺寸多样,可以单维或多维组合使用,适合于大部分对负载能力、运动精度有一定要求的场合。

**特点：**

- 采用线性滚珠导轨,运行平稳
- 主体材料为2024铝合金,表面氧化黑处理,强度较高、耐磨性好、外形美观
- 具有分厘卡和微调螺纹副2种驱动方式,分为左侧、右侧、中间驱动,使用灵活方便
- 产品尺寸丰富、交货期短、配套性好、性价比高

**命名规则：****ALB 13 (A)-40 20 SR****选型表**

型号	ALB13(A)-4020(xx)	ALB13(A)-6020(xx)	ALB25(A)-6520(xx)
行程(mm)	13	13	25
台面尺寸(mm)	40×40	60×60	65×65
厚度(mm)	20		
导轨	线性滚珠导轨		
驱动方式	螺纹副(带A为分厘卡)		
驱动位置	C: 中心驱动, SR: 右侧驱动, SL: 左侧驱动 CZ: 中心竖直驱动, RZ: 右侧竖直驱动, LZ: 左侧竖直驱动		
主体材料及表面处理	铝合金, 黑色阳极氧化处理		
自重(Kg)	0.12	0.2	0.25
灵敏度(μm)	≤2		
分厘卡最小读数(mm)	0.01		
静态平行度(mm)	≤0.06	≤0.1	
运动平行度(μm)	≤20		
直线度(μm)	≤10		
水平负载(Kg)	2	5	5
竖直负载(Kg)*	1	2	2

\*注: 竖直负载仅限“-XZ”型直线滑台

尺寸图:

ALB13-4020C

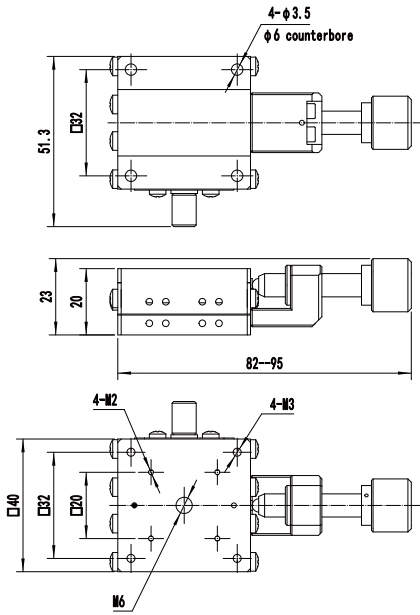
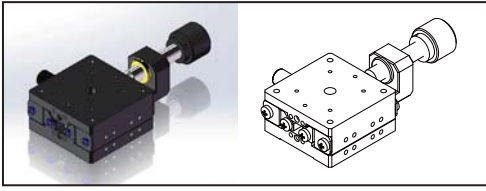

ALB13A-4020C

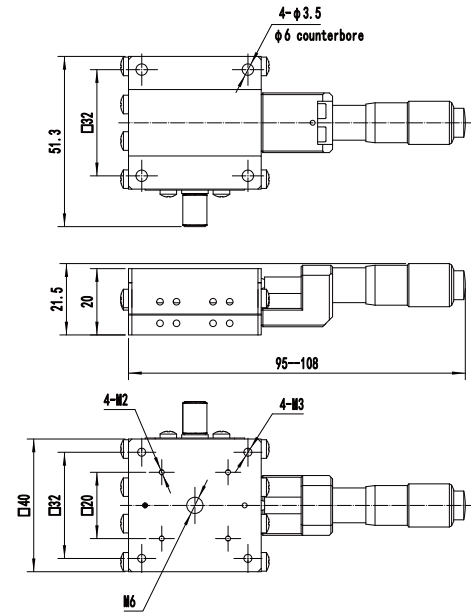
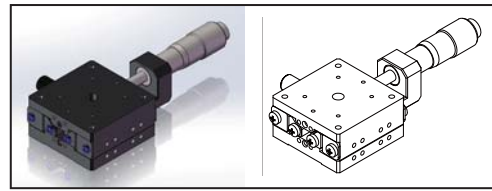

ALB13-4020SR

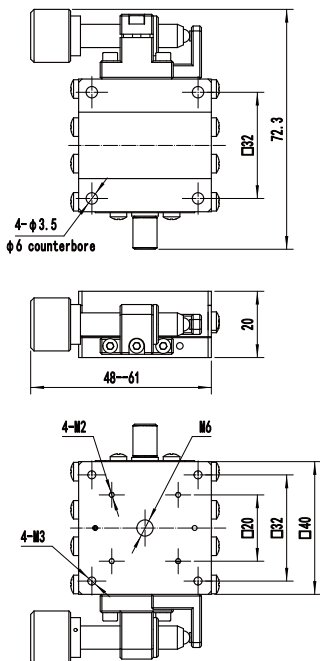
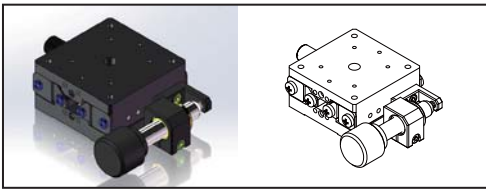

ALB13A-4020SR

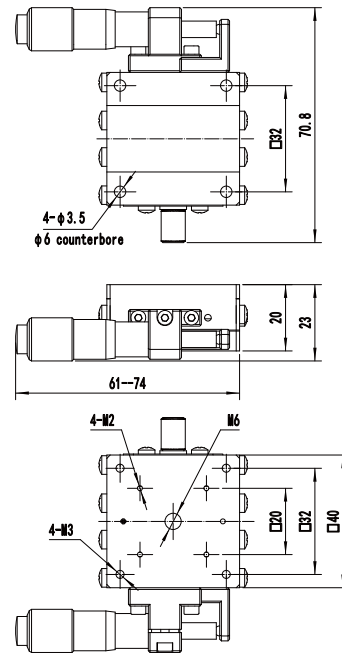
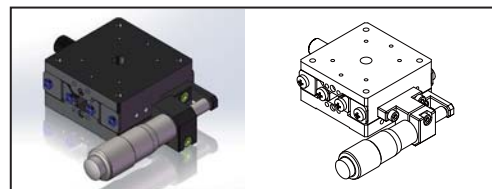

ALB13-4020SL

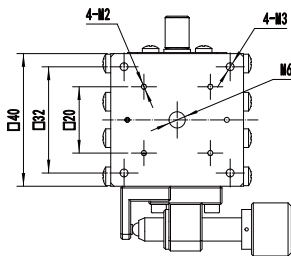
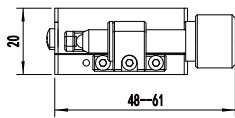
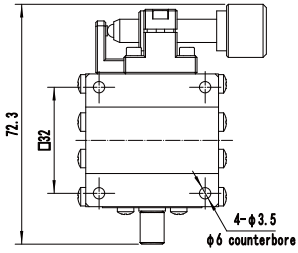
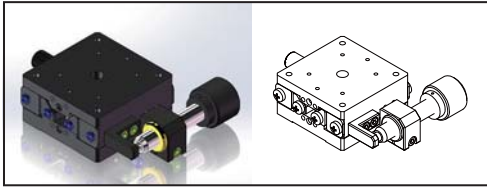

ALB13A-4020SL

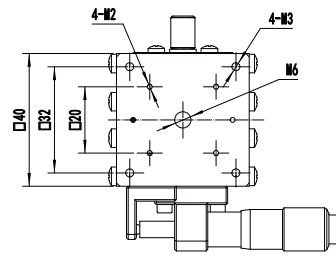
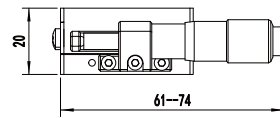
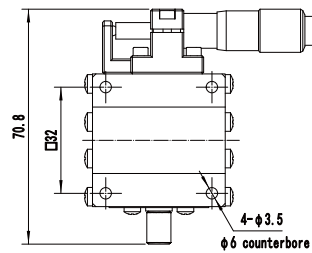
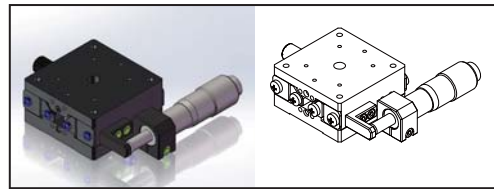

ALB13-4020CZ

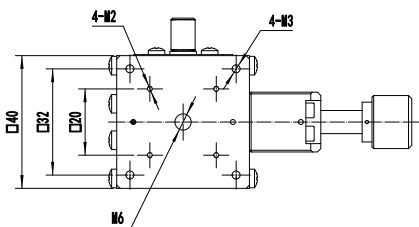
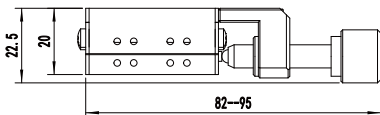
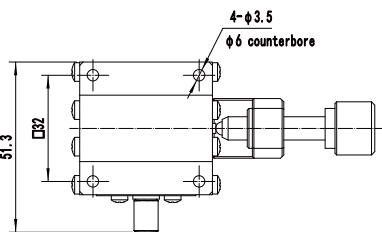
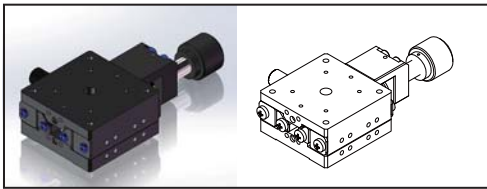

ALB13A-4020CZ

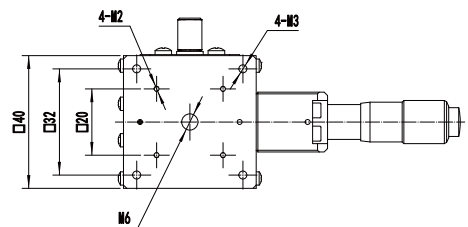
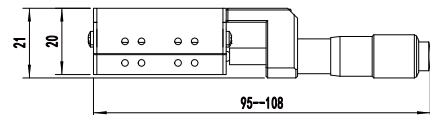
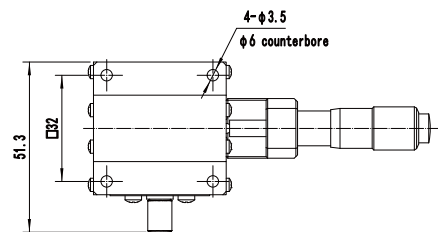
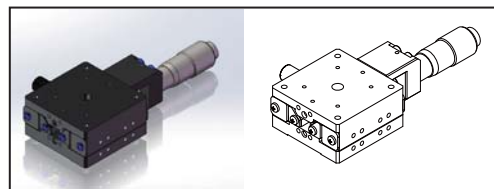

ALB13-4020RZ

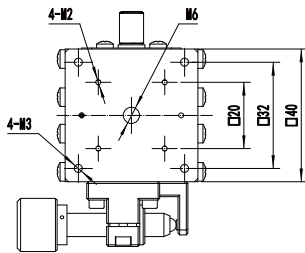
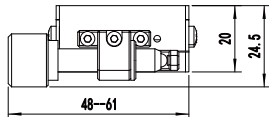
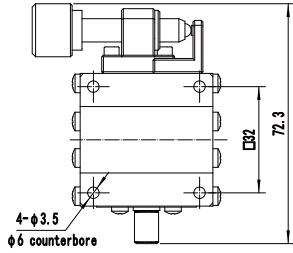
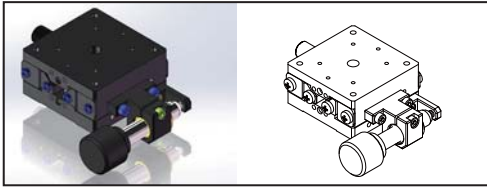

ALB13A-4020RZ

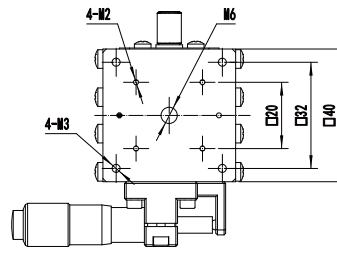
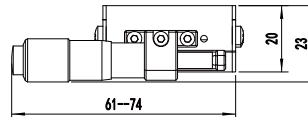
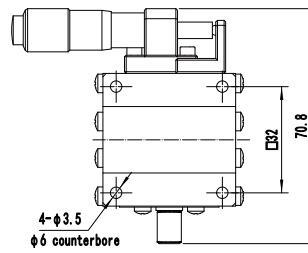
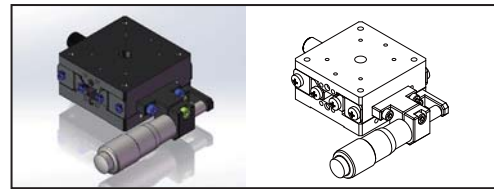

ALB13-4020LZ

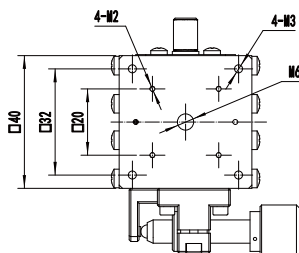
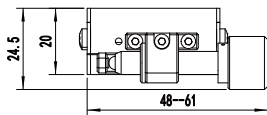
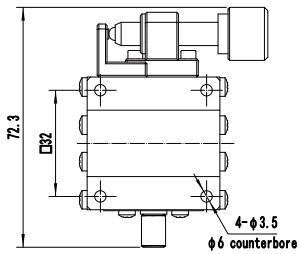
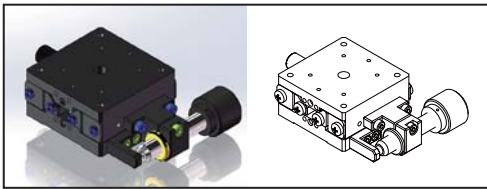

ALB13A-4020LZ

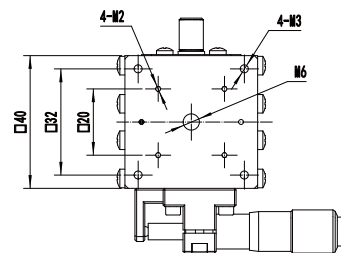
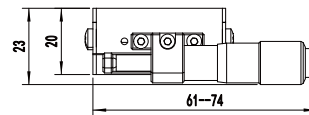
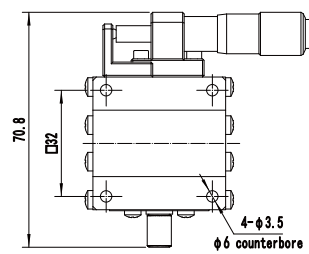
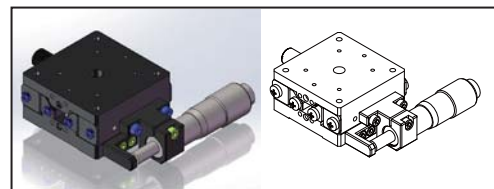

ALB13-6020C

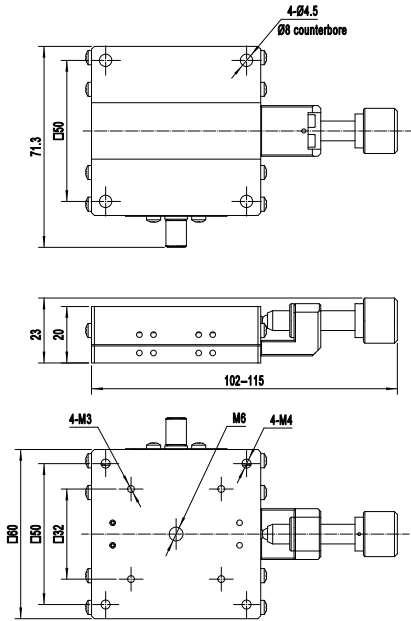
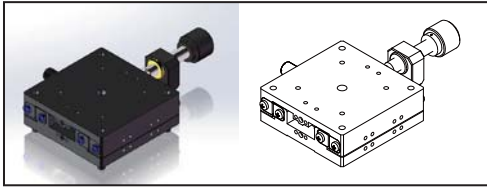

ALB13A-6020C

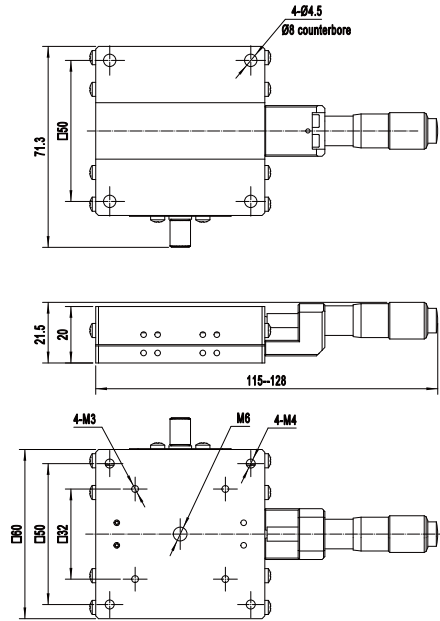
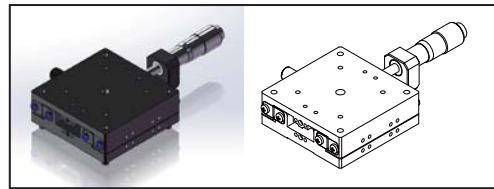

ALB13-6020SR

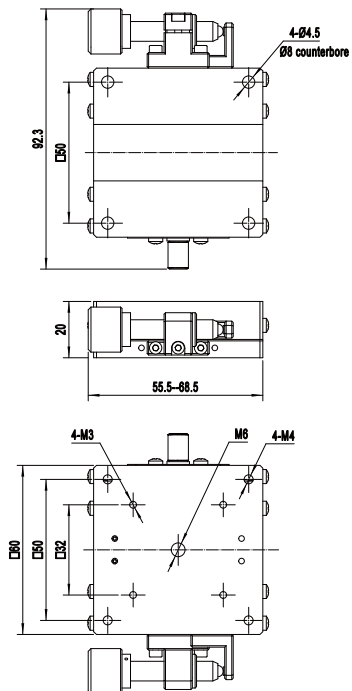
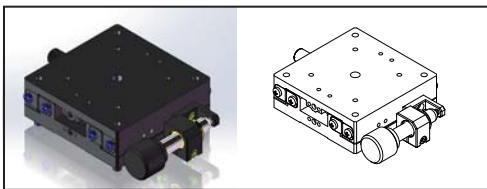

ALB13A-6020SR

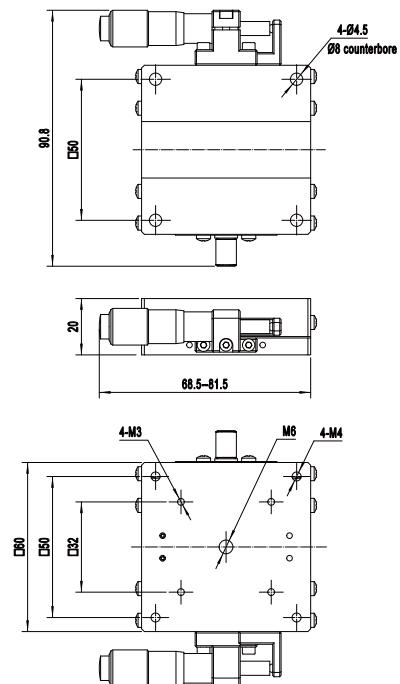
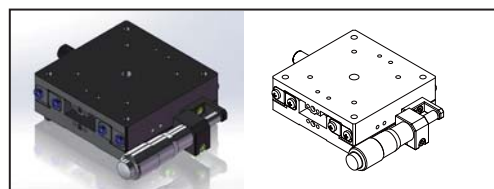

ALB13-6020SL

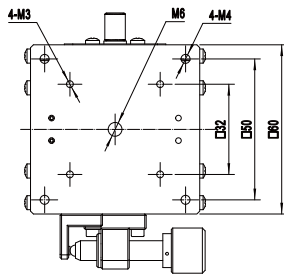
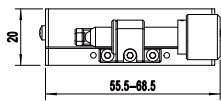
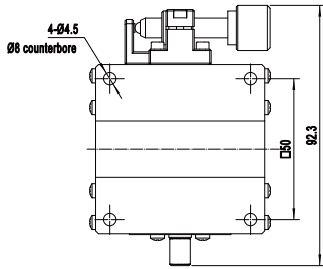
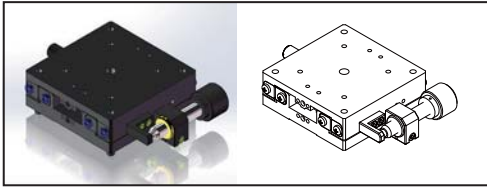

ALB13A-6020SL

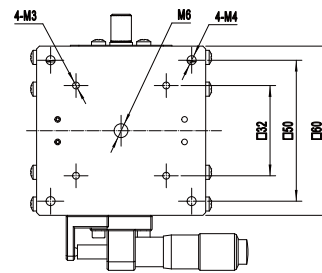
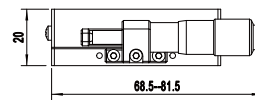
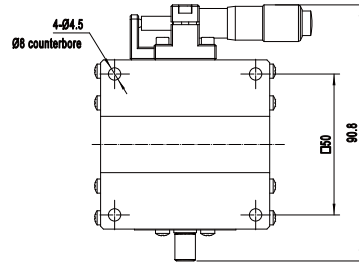
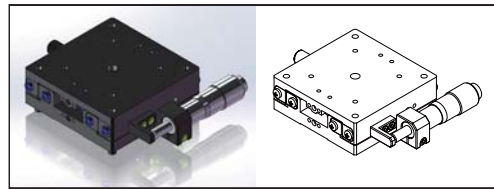

ALB13-6020CZ

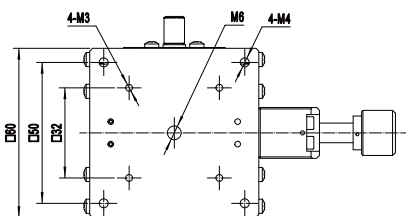
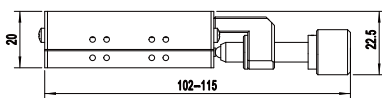
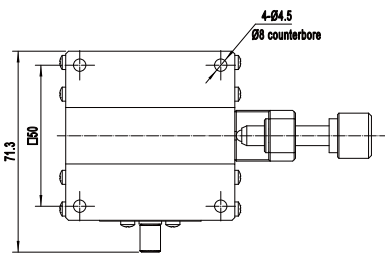
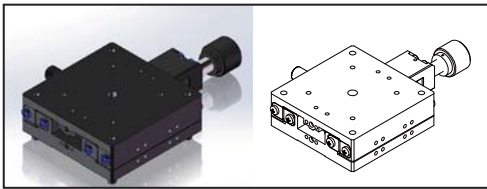

ALB13A-6020CZ

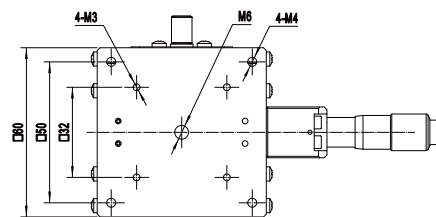
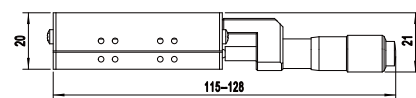
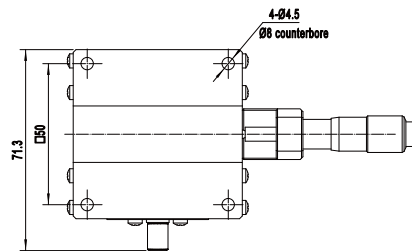
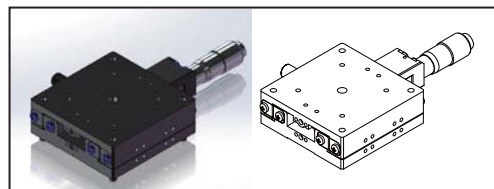

ALB13-6020RZ

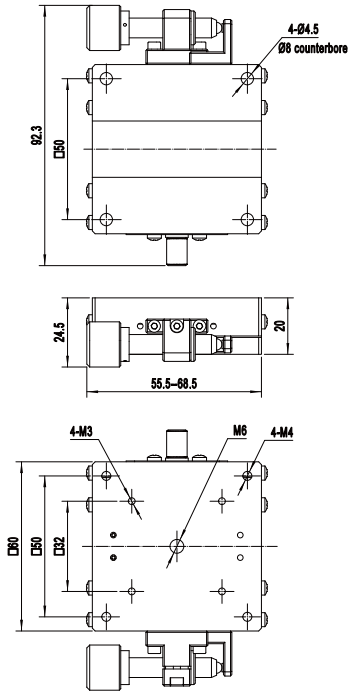
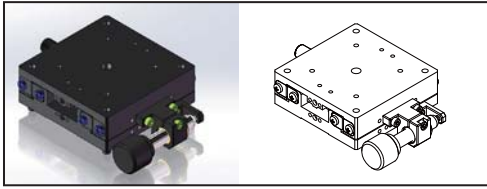

ALB13A-6020RZ

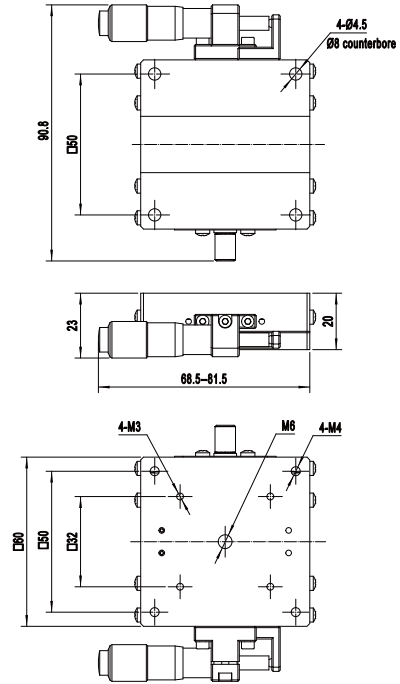
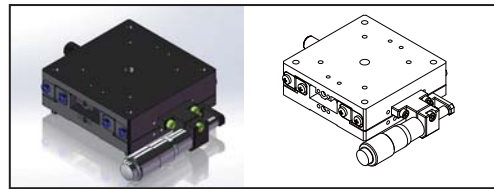

ALB13-6020LZ

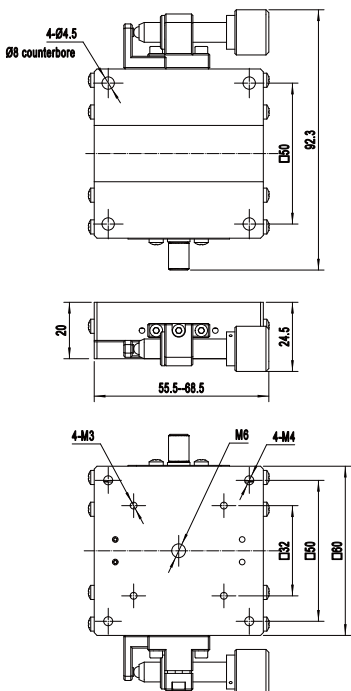
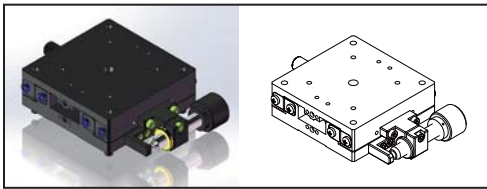

ALB13A-6020LZ

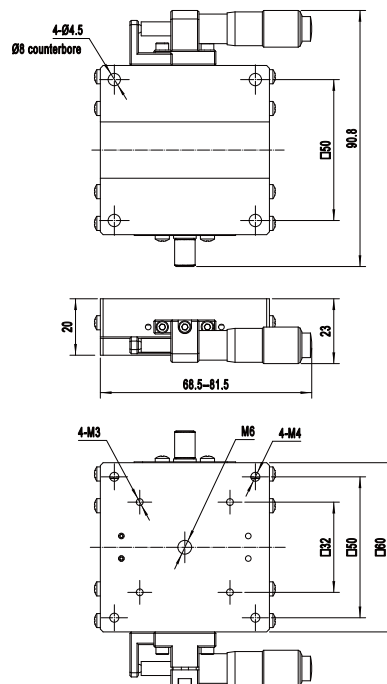
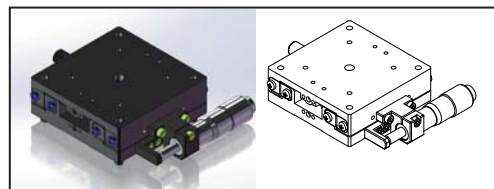

ALB25-6520C (本品带GB70.2安装螺钉)

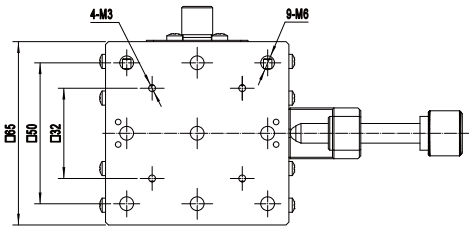
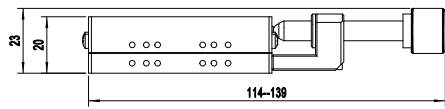
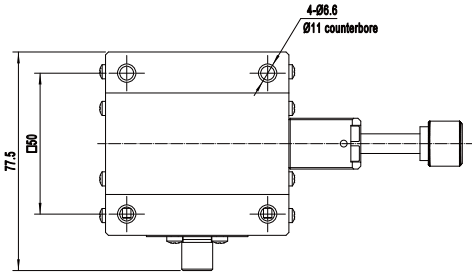
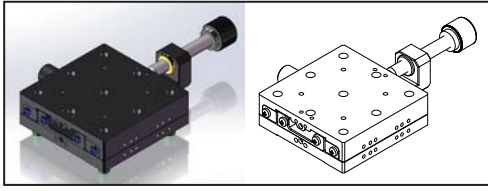

ALB25A-6520C (本品带GB70.2安装螺钉)

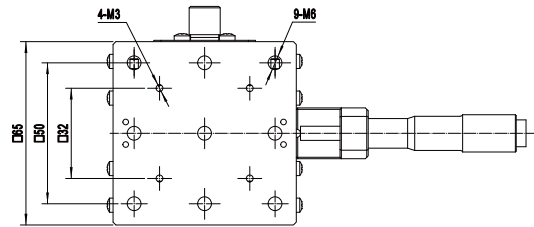
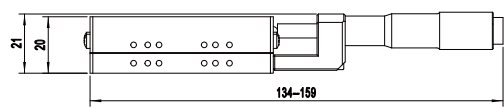
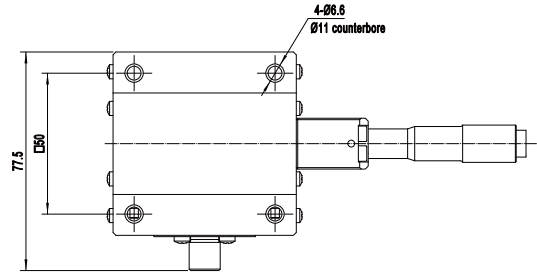
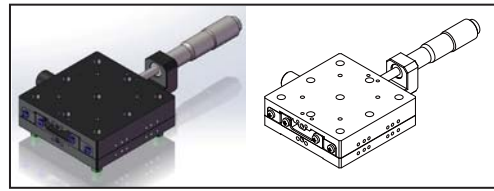

ALB25-6520SR (本品带GB70.2安装螺钉)

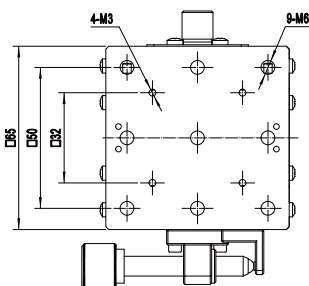
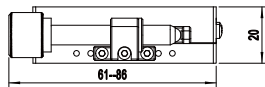
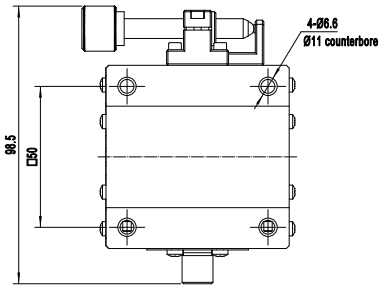
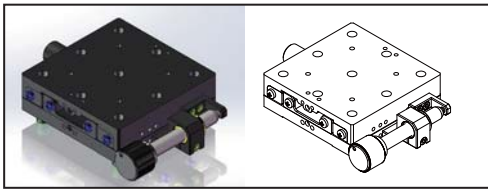

ALB25A-6520SR (本品带GB70.2安装螺钉)

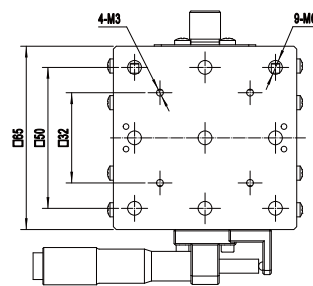
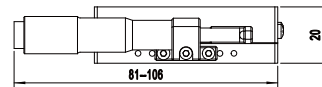
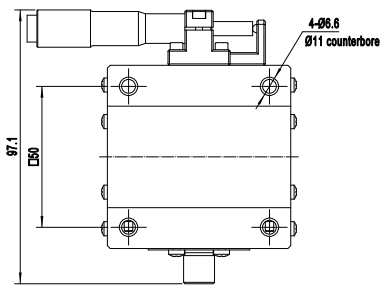
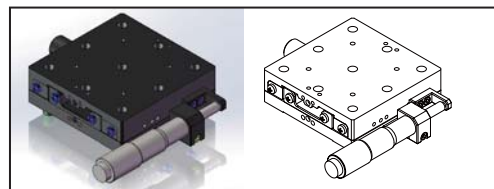



ALB25-6520SL (本品带GB70.2安装螺钉)

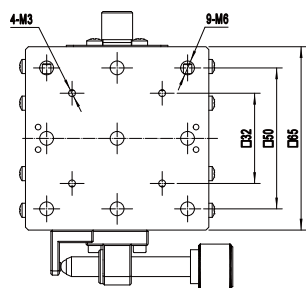
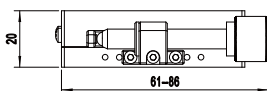
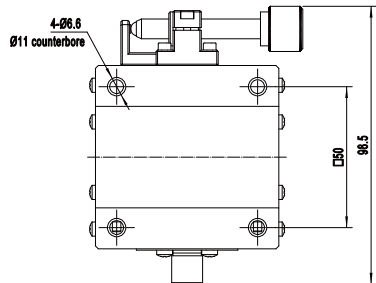
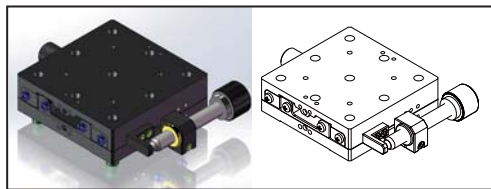

ALB25A-6520SL (本品带GB70.2安装螺钉)

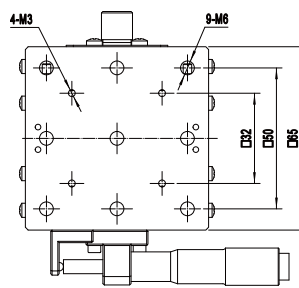
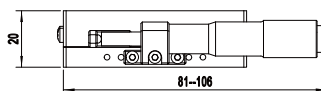
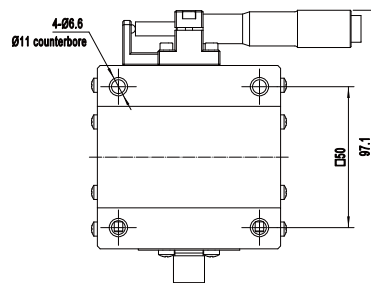
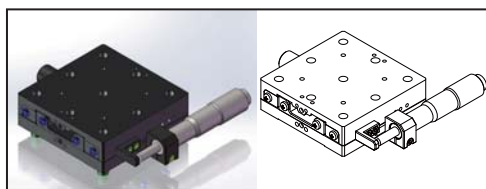

ALB25-6520CZ (本品带GB70.2安装螺钉)

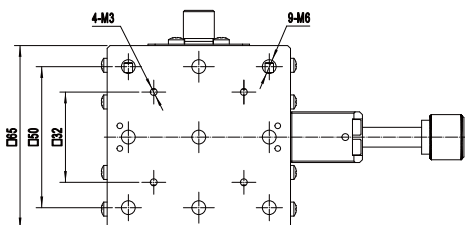
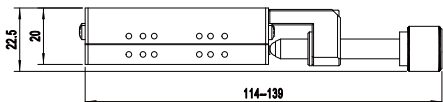
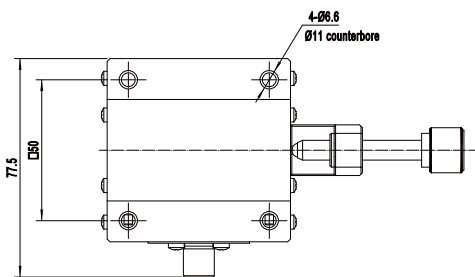
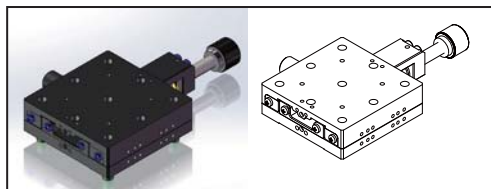

ALB25A-6520CZ (本品带GB70.2安装螺钉)

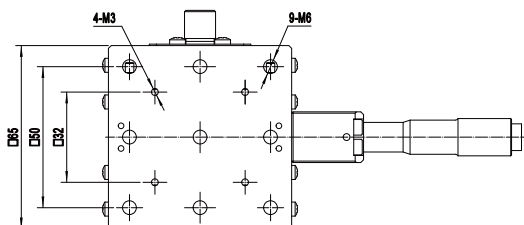
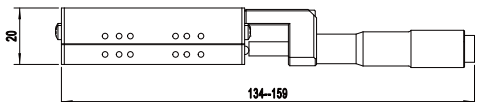
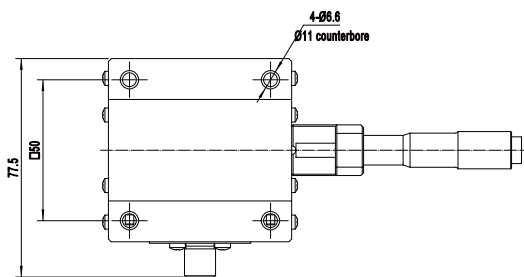
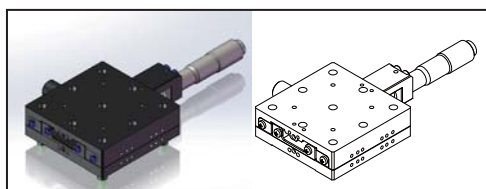

ALB25-6520RZ (本品带GB70.2安装螺钉)

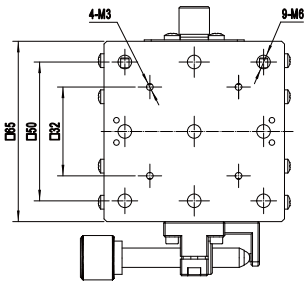
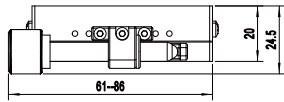
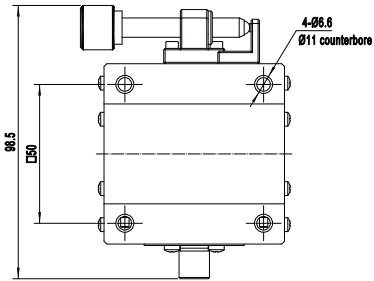
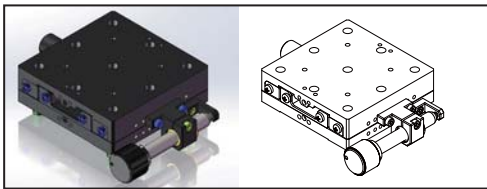

ALB25A-6520RZ (本品带GB70.2安装螺钉)

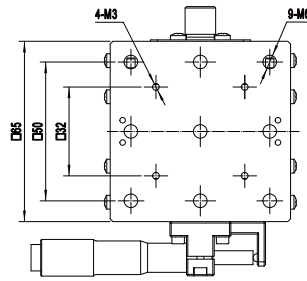
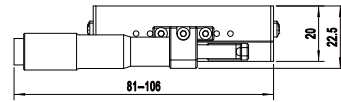
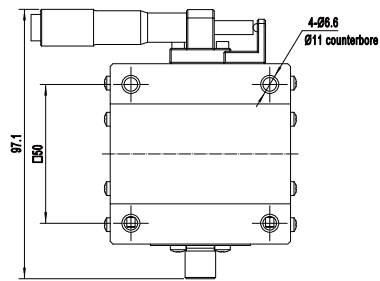
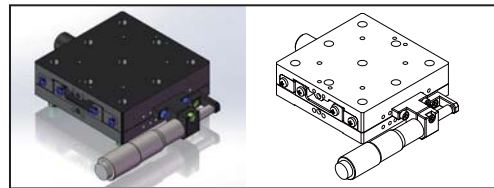

ALB25-6520LZ (本品带GB70.2安装螺钉)

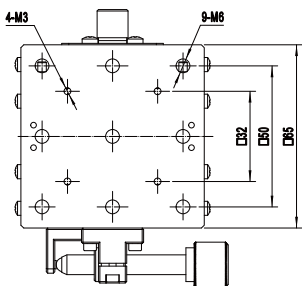
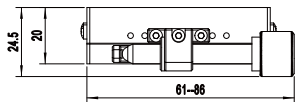
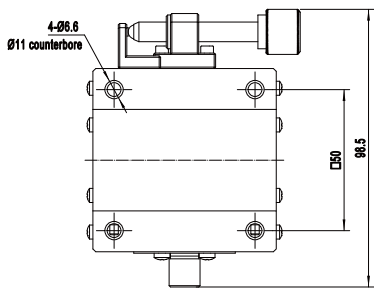
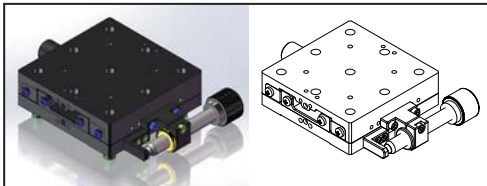

ALB25A-6520LZ (本品带GB70.2安装螺钉)

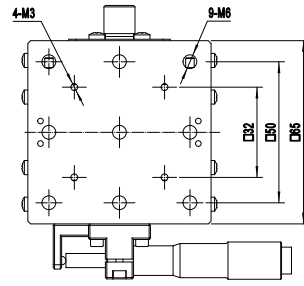
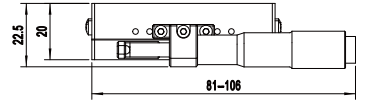
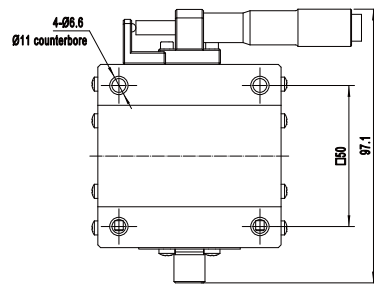
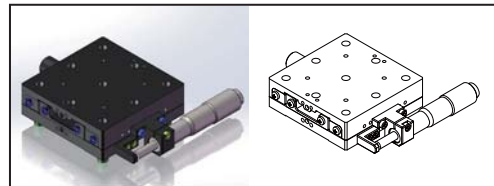

转接附件详见313~318页。