

M5X0.2 ADJUSTER SCREWS
 PROVIDES +/-2.5° TOTAL ANGULAR DISPLACEMENT
 (0.18° PER REVOLUTION)
 2 PLACES
 2.0mm [5/64in] HEX

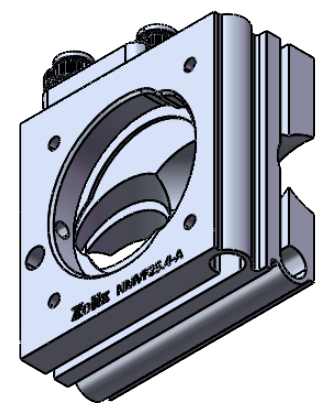
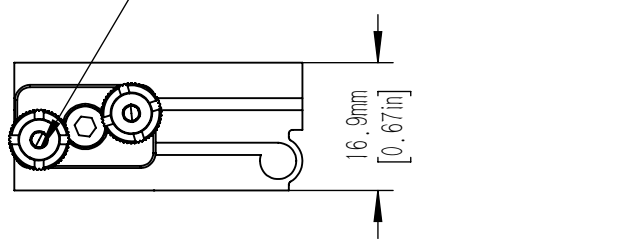

DRAWING PROJECTION				NMVF25.4-A					
DRAWN	NIC	DATE	1st/Feb/2026	STAINLESS STEEL FLEXIBLE TOP-ADJUSTMENT MOUNT		MATERIAL	WEIGHT	SCALE	REV
APPROVAL	DICK	DATE	1st/Feb/2026			FOLLOW THE PARTS	0.038	1:1	V1
THE DRAWINGS ARE ONLY FOR TYPE SELECTION INFORMATION						shop.zolix.com.cn			