

M6 x 1.0 MOUNTING HOLE
12.0mm [0.47in] DEEP

[0.98in]
Ø 25mm

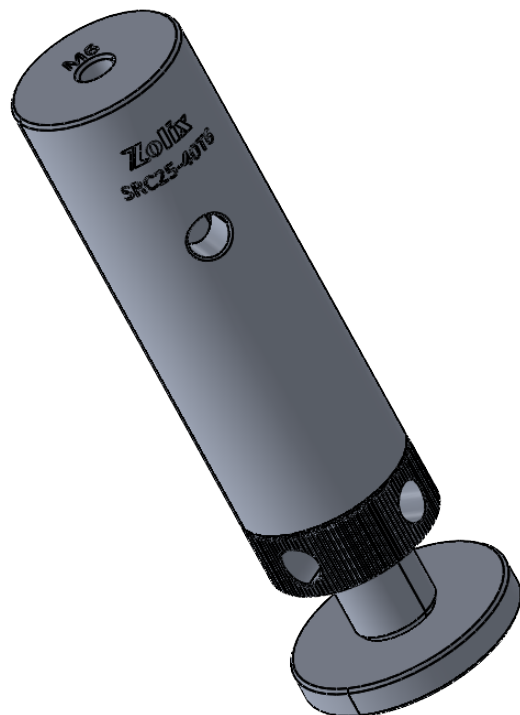

M12 X 1.0 THREAD PROVIDES
1.0 mm/REV RESOLUTION

φ 6 mm [0.23in] HOLES
FOR APPLYING EXTRA TORQUE
4 PLACES, EQUALLY SPACED

φ 6 mm [0.24in] THRU HOLE FOR
APPLYING EXTRA TORQUE

[0.19in]
4.7mm

[0.39in]
10mm

[2.76in]
70mm

THE ADJUSTABLE HEIGHT RANGE IS FROM
96 mm [3.78 in] TO 136 mm [5.35 in]

[1.26in]
Ø 32mm

3mm HEX
TO REMOVE BASE

DRAWING
PROJECTION



SRC25-40T6

Zolix

	NAME	DATE
DRAWN	NIC	23rd/June/2025
APPROVAL	DICK	23rd/June/2025

THE DRAWINGS ARE ONLY FOR
TYPE SELECTION INFORMATION

25mm HEIGHT-ADJUSTABLE
OPTICAL CONNECTING ROD

MATERIAL	WEIGHT	SCALE	REV
FOLLOW THE PARTS	0.116	1:2	V1

shop.zolix.com.cn